

Thiele-Small Parameters

Qms	3.11	
Qes	1.00	
Qts	0.76	
Mms	5.46	g
Vas	1.49	l
Cms	0.42	mm/N
Xmax	1.15	mm
u0	0.17	%
Sd	50.26	cm ²
Bl	3.50	T*m
Rms	0.86	Kg/s

Electrical Characteristics

Nominal Impedance	4	Ohm ± 12%
Rated Power DIN 45573	50*	Watt
Rated Power DIN 45500	100	Watt
Resonance Frequency	105	Hz ± 6 Hz
Flux Density	9700	Gauss ± 7%
Voice Coil Resistance	3.4	Ohm ± 10%
Voice Coil Diameter	25.23	mm
Sensitivity (1w, 1m)	87.00	dB
Voice Coil Induc. (1KHz.)	0.189	mH



Measurement Conditions

Frequency Response: The Speaker is Mounted On a DIN 45575 Baffle.

Microphone Distance: 1m.

Measuring Power, Held Costantly, is 1 Watt Across a DC Resistance of Normal Imped.

LOUDSPEAKER

*= Power specifications: Filtered by a 2° crossover network at 80 Hz

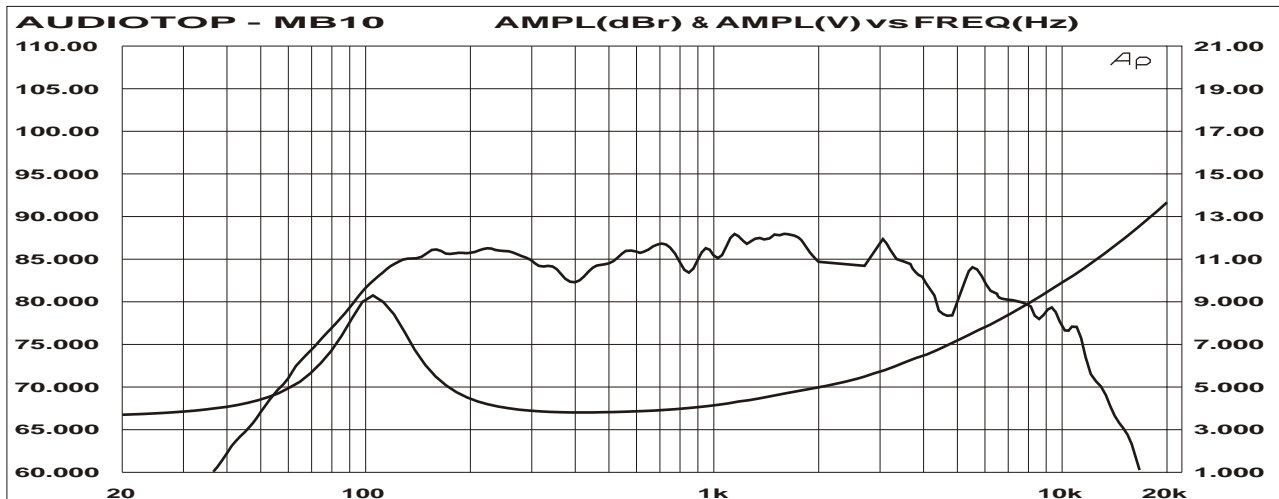

FREQUENCY RESPONSE AND IMPEDANCE :

NOTES: Black glass fiber cone, foam surround and aluminium voice coil former

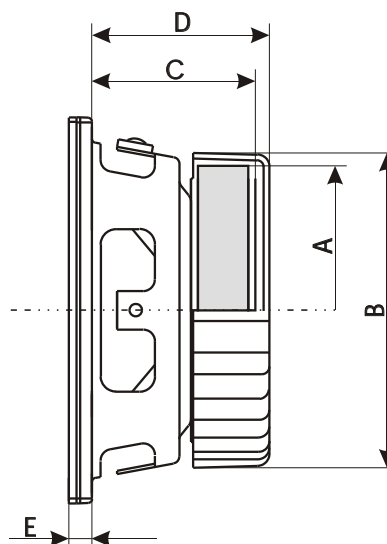
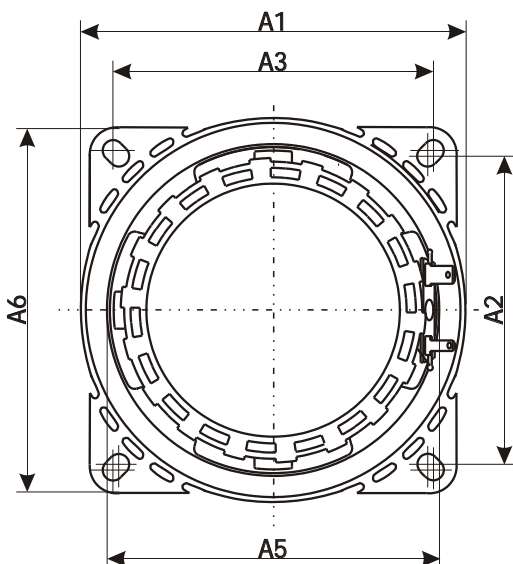

- A → 74 mm.
- A1 → 100 mm.
- A2 → 82 mm.
- A3 → 82 mm.
- A4 → --- mm.
- A5 → 88 mm.
- A6 → 94 mm.
- B → 80 mm.
- C → 45 mm.
- D → 48 mm.
- E → 8 mm.
- F → --- mm.
- G → --- mm.